

L3C07U-9x LCD module

■ Basic specifications

Photo		
Technology		D8
Screen size	Diagonal	1.87cm(0.74")
	H x V (mm)	16.32 x 9.18
Pixel number	H x V	1922 x 1082 (1080P)
Pixel pitch	H x V (μ m)	8.5 x 8.5
Outside Dimension	H x V x D (mm)	27.2 x 26.8 x 4.4
Aspect Ratio		16:9
Display Colors		Monochrome
Micro Lens Array		With Micro Lens Array
Liquid Crystal		VA mode

Dimensional Outline Drawing

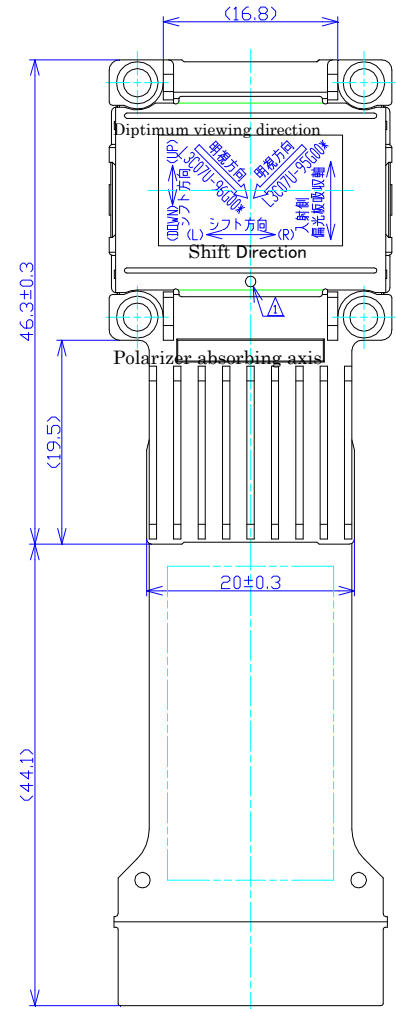
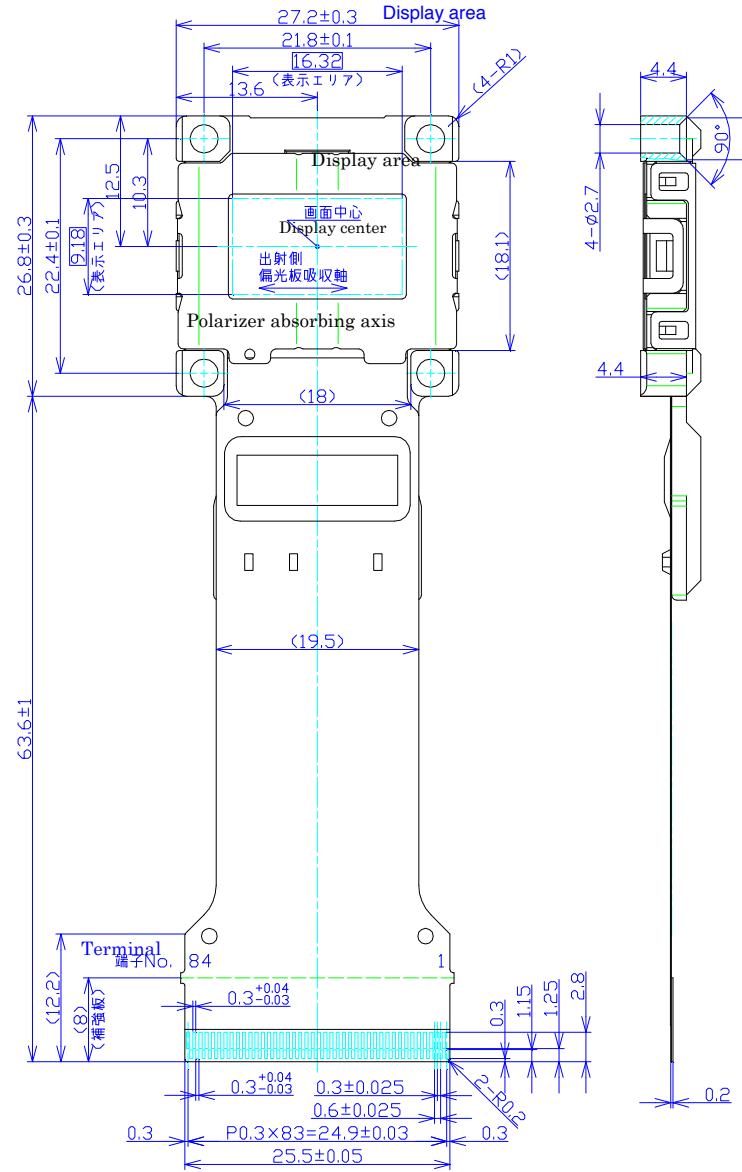
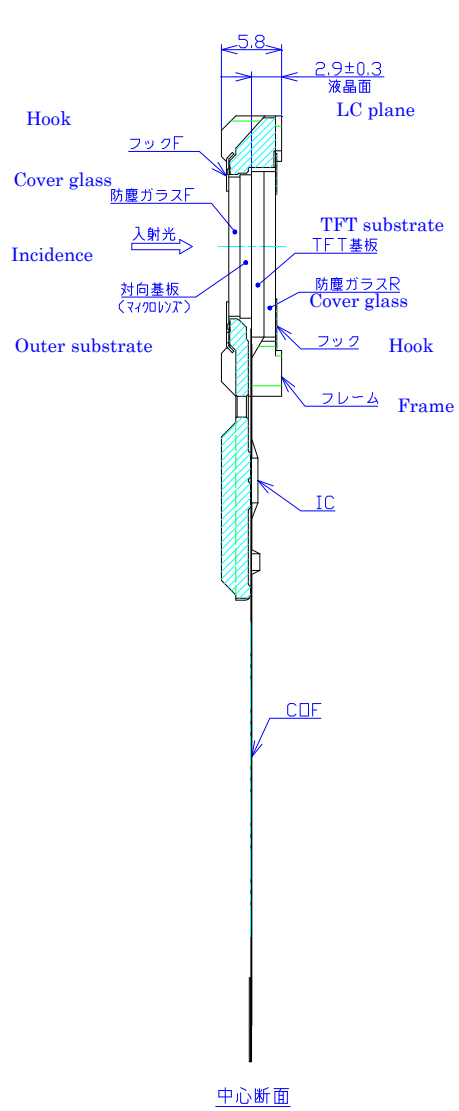

●For 3D Panel (E74A)

• external view (dimension: W240mm x H200mm)

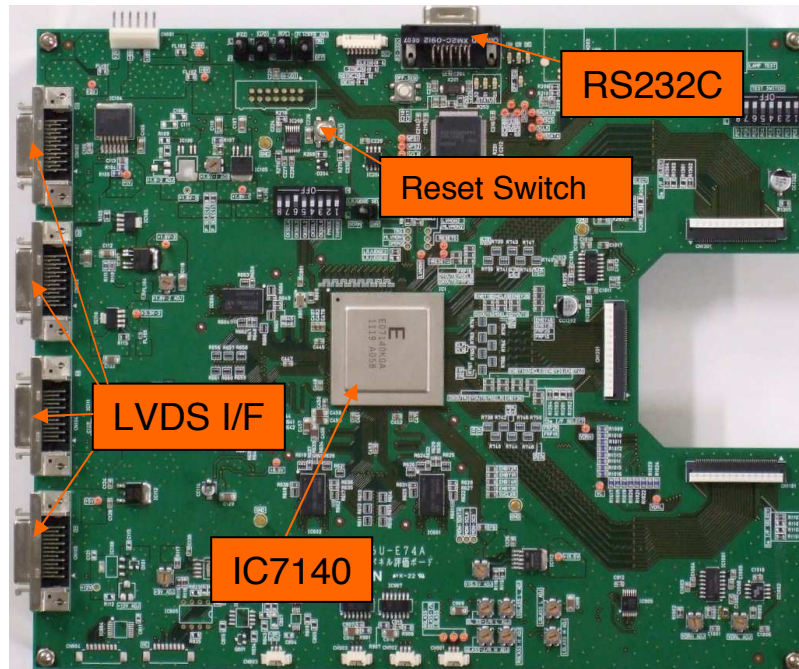

• IC Block Diagram

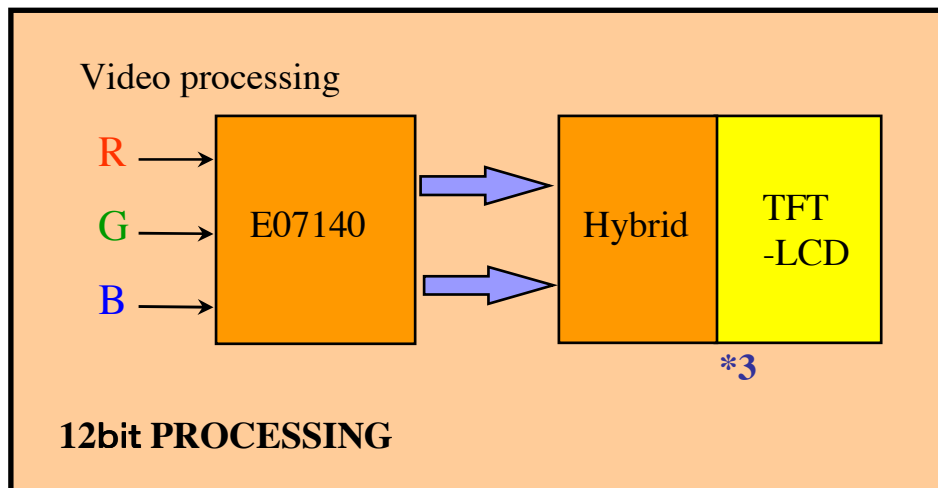

1) Evaluation board is accompanied by the following documents.

"instruction book", "config file (a sheet of FD)"

2) LCD Panel is not attached. Please purchase it separately.

3) Extra preparation by customer

a. DC stabilized power supply

b. Video signal source (LVDS)

c. RS232C cable (for configuration)

d. Optical source for evaluation, polarizer etc.

Usage notice

a. Information in these documents is subject to be changed without notice.

b. None of the documents contained herein may be copied or reprinted, whether in full or in part, without prior notice.

c. Mentioned contents of the document were described as of August 2012.

<Contact>

©SEIKO EPSON CORPORATION 2012

Visual Device Design & Engineering Department

Visual Products Operations Division

1010 Fujimi, Fujimi-machi, Suwa-gun, Nagano-ken

399-0295 JAPAN

TEL 0266-62-6528

<http://www.epson.jp/device/https>